



*Building the most accurate
and heaviest built spreader
since 1969.*

*Application rates from 60
pounds per acre on fertilizer to
over six tons per acre on lime
(depending on chain width).*



Chandler Spreader w/ Mid-Tech Legacy 6000

*All Chandler Spreaders
can be equipped with
variable rate controls from
Mid-West Technologies.
(Mid-Tech Legacy 6000)*

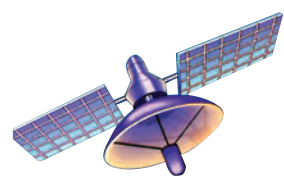

C **HANDLER EQUIPMENT CO.**

Gainesville, Georgia 30503
Toll Free 1-800-243-3319
www.chandlerequipment.net

CHANDLER TRUCK-MOUNTED FERTILIZER AND LIME SPREADER *(with Spread-Master Technology)*

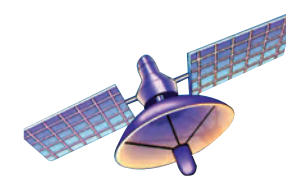

C **HANDLER EQUIPMENT CO.**

Gainesville, Georgia 30503
Toll Free 1-800-243-3319
www.chandlerequipment.net

Chandler "FT—EXW" Hopper

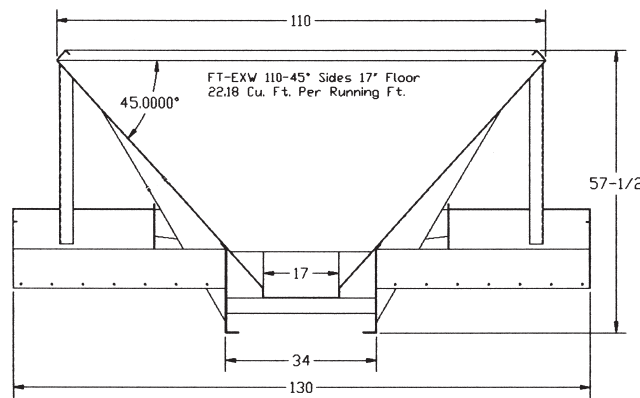

Available in 10', 11', 12', and 13' Lengths
Catwalks 130" Wide

	10' UNIT	11' UNIT	12' UNIT	13' UNIT
Hopper Capacity (Struck Level)	221 Cu. Ft.	244 Cu. Ft.	266 Cu. Ft.	288 Cu. Ft.
Payload (struck level) (@ 65# Material)	14,365 Lbs.	15,860 Lbs.	17,290 Lbs.	18,720 Lbs.
Hopper Capacity (Heaped and Tarped)	251 Cu. Ft.	276 Cu. Ft.	301 Cu. Ft.	326 Cu. Ft.
Payload (Heaped) (@ 65# Material)	16,315 Lbs.	17,940 Lbs.	19,565 Lbs.	21,190 Lbs.

Chandler "FT" Hopper

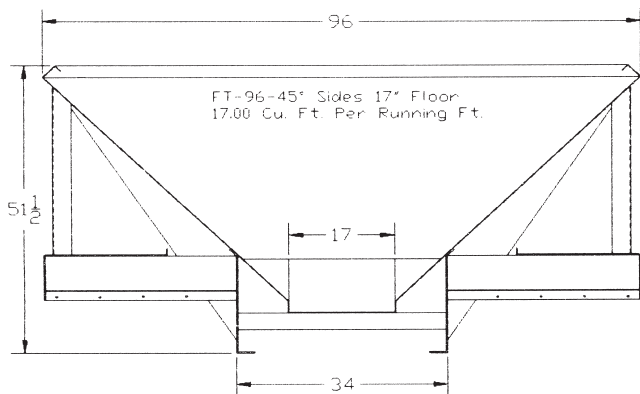

Available in 11', 12', 13', 14' and 15' Lengths
Catwalks 102" Wide

	11' UNIT	12' UNIT	13' UNIT	14' UNIT	15' UNIT
Hopper Capacity (Struck Level)	185 Cu. Ft.	202 Cu. Ft.	219 Cu. Ft.	236 Cu. Ft.	254 Cu. Ft.
Payload (struck level) (@ 65# Material)	12,000 Lbs.	13,130 Lbs.	14,235 Lbs.	15,340 Lbs.	16,510 Lbs.
Hopper Capacity (Heaped and Tarped)	220 Cu. Ft.	241 Cu. Ft.	261 Cu. Ft.	282 Cu. Ft.	303 Cu. Ft.
Payload (Heaped) (@ 65# Material)	14,300 Lbs.	15,665 Lbs.	16,965 Lbs.	18,330 Lbs.	19,700 Lbs.

Chandler "FT—LH" Hopper

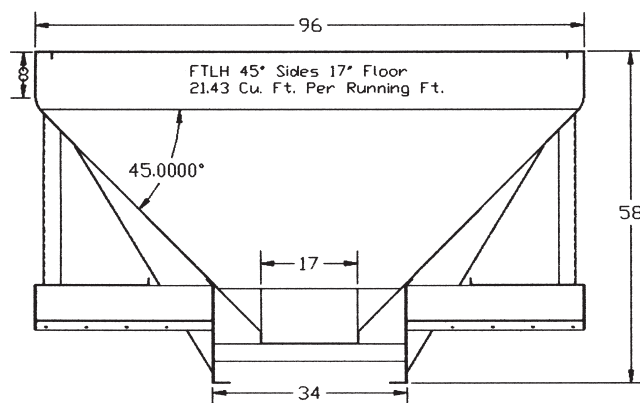

Available in 11', 12', 13', 14' and 15' Lengths
Catwalks 102" Wide

	11' UNIT	12' UNIT	13' UNIT	14' UNIT	15' UNIT
Hopper Capacity (Struck Level)	233 Cu. Ft.	255 Cu. Ft.	298 Cu. Ft.	276 Cu. Ft.	320 Cu. Ft.
Payload (struck level) (@ 65# Material)	15,145 Lbs.	16,575 Lbs.	17,940 Lbs.	19,370 Lbs.	20,800 Lbs.
Hopper Capacity (Heaped and Tarped)	269 Cu. Ft.	295 Cu. Ft.	319 Cu. Ft.	346 Cu. Ft.	370 Cu. Ft.
Payload (Heaped) (@ 65# Material)	17,485 Lbs.	19,175 Lbs.	20,735 Lbs.	22,490 Lbs.	24,050 Lbs.

All Products and Specifications subject to change without notice.
Drawing shown with 45 degree slope sides and 16" mesh type chain.

Hopper Construction:

Available in three types of material:

1. Mild Steel with 304 Stainless Steel at critical corrosion points.
2. 409 Stainless Steel (corrosion resistant stainless but has to be painted)
3. 304 Stainless Steel (top of the line in spreader manufacturing)

Available in 45, 52 or 60 Degree Slope on Sides

(Drawings shown with 45 degree slope sides, width will vary depending on degree of slope)

Conveyor Specs:

Available in three types:

1. 1" x 1" Mesh Type, Heavy Duty Type 304 Stainless Steel—Available in 16", 18", 20", and 24" Widths.
2. Bar Type Chain
3. Belt Over—Bar type Chain

Spinner Specifications:

1. Twin "Dish Type" Spinners, 24" diameter with 6 blades per spinner especially engineered for extremely accurate spread patterns. Mild Steel Construction. Also available in 304 Stainless Steel.
2. High Pressure spinner motors mounted over-head to keep motors out of fertilizer and other contaminants for longer life.
3. Material Divider specially engineered "Screw Type" adjustable material divider for proper material placement on spinners to insure uniform spread patterns at all application rate and spread widths from 30'–40' Lime, 50'–60' Fertilizer with standard spinner system.
4. **Optional: Spread-Master Technology**—four-blade configuration spinners and a specially-designed flow divider for wide swath applications. (60' Lime—80' Fertilizer)

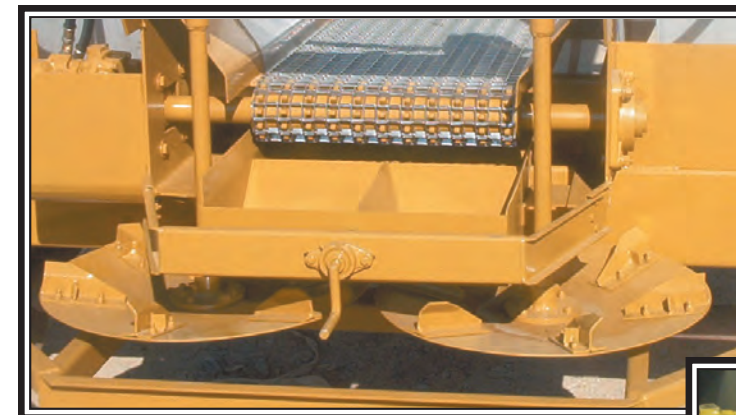

Chandler Spreader with Standard Spinners

Spread Patterns on Fertilizer from 50'–60' with Unmatched Accuracy.

Chandler Spreader with Spreader-Master Technology

Spread Patterns on Fertilizer up to 90', Lime up to 60'.

